

Join us for expert DIY & product support at:  
[www.amtechdiy.com/knowhow](http://www.amtechdiy.com/knowhow)

## siphon pump

**Stock Code: S1495**

### Instructions for use:

#### To Siphon:

1. Insert one end of each of the red hoses through a black connector (part A).
2. Insert the open end of the red hose into the top and bottom nozzles on the pump housing and push the black connectors (part A) over the nozzle, ensuring the hoses are securely inserted.
3. Put the other end of the red hose from the top nozzle (intake) into the liquid needing to be transferred. Then insert the other end of the red hose from the bottom nozzle (discharge) into the liquid to be discharged.

**Note:** to enable siphoning to start, the discharge (bottom) hose must be lower than the intake (top) hose.

4. Prime the pump by pumping the handle 3-4 times. Once the liquid begins to flow, it will flow without further pumping.

**After siphoning petrol, oil or any flammable liquid, it is very important to clean the pump thoroughly using the appropriate cleaning solution.**

#### To change oil:

Follow steps 1 & 2 above. Then insert the small black dipstick tube into the black adapter (part B) and insert the adapter into the top (intake) hose as shown by the arrow indicated. Insert the other end of the small black dipstick tube into the engine dipstick hole until it reaches the bottom of the sump. Place the red bottom (discharge) hose into an oil drain pan and start pumping.

#### To use as an air pump:

Place the short black air pressure hose into the bottom nozzle (discharge) securely. Insert the valve connector (part C) into the end of the hose with the steel spring and attach to the required tyre valve. To inflate footballs, beach balls etc. place the correct inflation nozzle (parts D or E) into the valve connector (part C) and begin inflating.

#### Cleaning instructions:

Usually flushing the pump and hoses with water is all that is needed for cleaning. For a more thorough clean, the Siphon Pump can be disassembled, and cleaned using an appropriate cleaning solution.

Please keep these instructions for future reference.

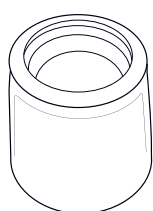

Part A

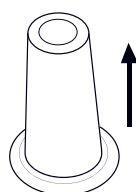

Part B

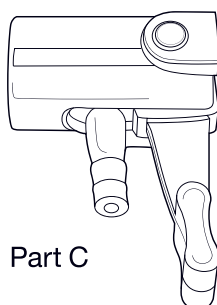

Part C

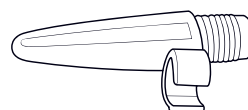

Part D

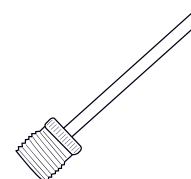

Part E